



2005

2000 I-30 E
Greenville, TX 75402

Monday, November 10, 2025

County: Hunt County

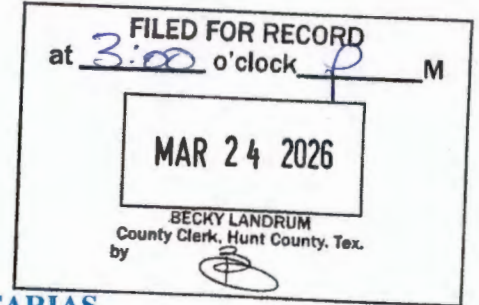

Farmers Electric Cooperative Member: REYES JIMENEZ FARIAS
Service Order Number: 2026021564

Greetings:

Farmers Electric Cooperative, Inc. is requesting permission to construct electrical power distribution facilities which will cross **CR 3602**

Site location map/construction sketches are attached. The construction sketch details the proposed work. The proposed electrical service will be constructed:

- Overhead - All road crossings will have a minimum vertical clearance of 22 feet.
- Underground - All underground bore crossings are PVC encased 4' of coverage from the lowest point of the Right of Way.

If you have any questions, please contact me at any time.

Sincerely,

Shaya Smith
ssmith@farmerselectric.coop
Engineering Coordinator

Enclosures

County Approval Section:

Approved: _____ Denied: _____

Authorized Signature: _____ Date: _____



2000 I-30 E
Greenville, TX 75402

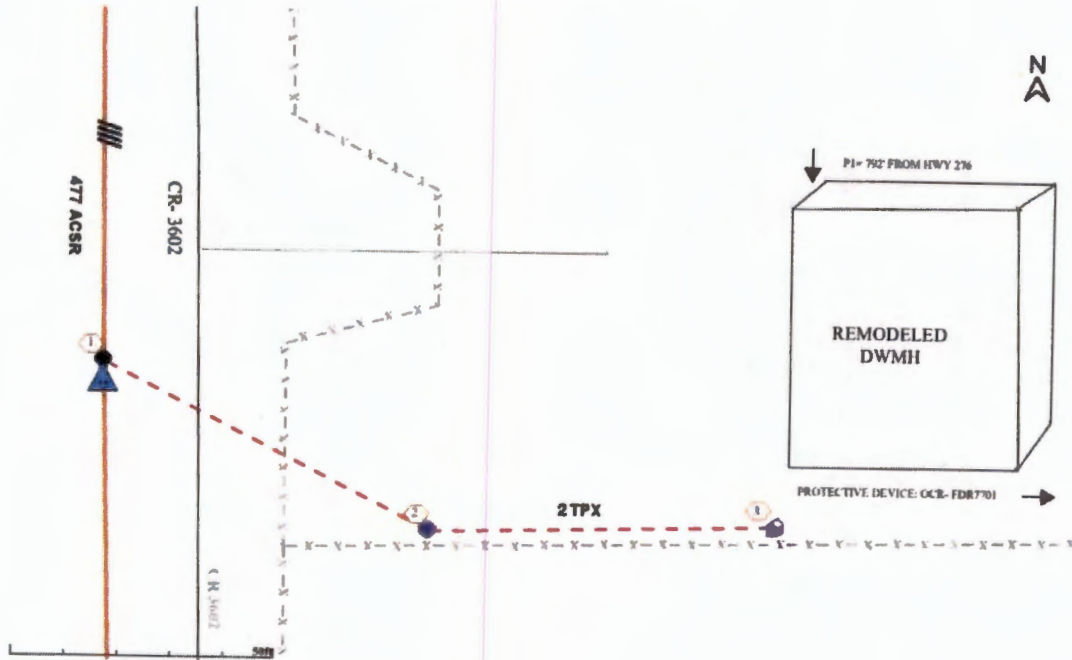



2000 I-30 E
Greenville, TX 75402

